

FILED
GREENVILLE CO., S.C.
OCT 19 10 20 AM '84
DONNIE S. FARMERLEY
R.M.C.

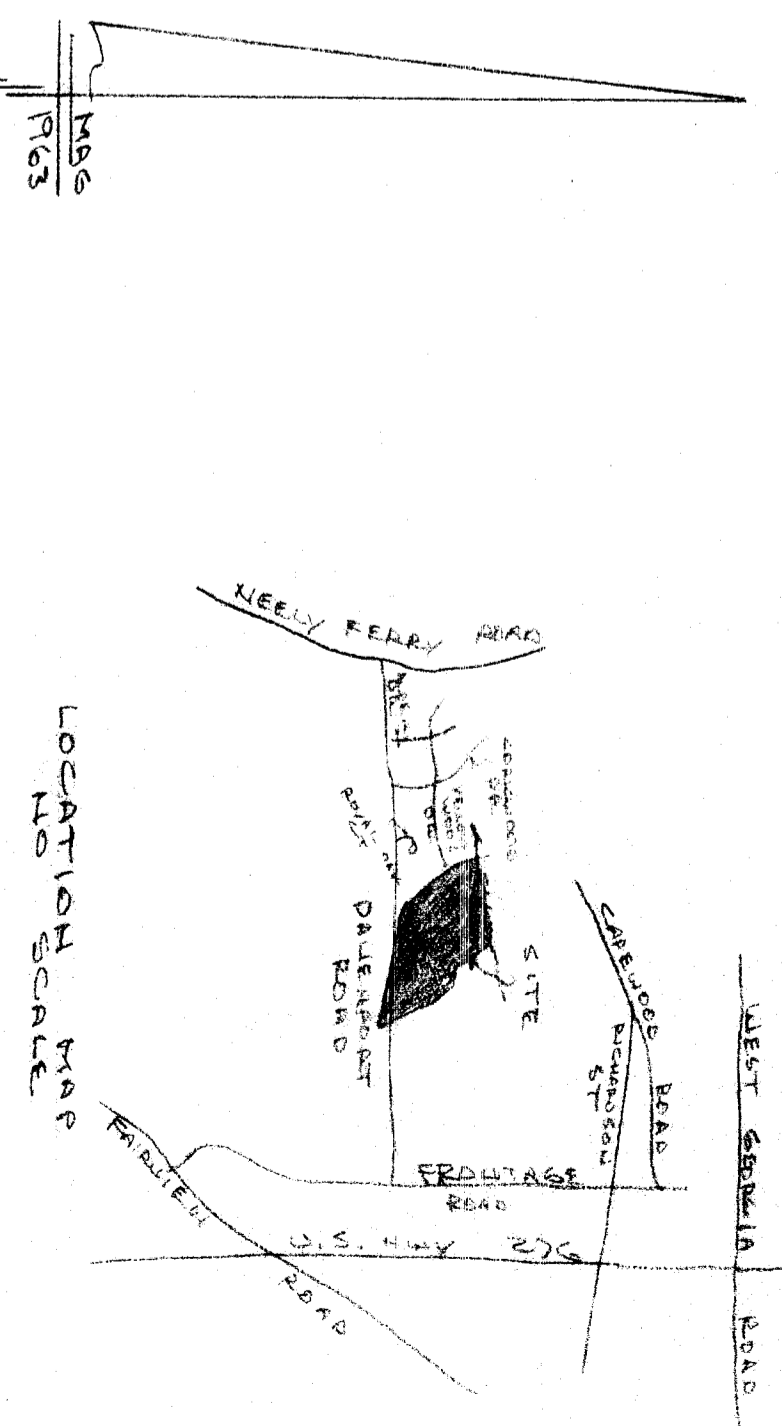

LIVE	BEARING	DISTANCE
1	N 89° 51'E	80.2
2	S 66° 15'E	150.4
3	N 51° 42'E	45.5
4	N 70° 07'E	122.3
5	N 3° 19'W	34.5
6	S 61° 54'E	85.7
7	N 59° 10'E	60.1
8	N 86° 26'E	90.3
9	N 17° 04'E	94.3
10	N 73° 40'E	72.2
11	S 44° 38'E	116.7
12	N 41° 52'E	68.2
13	N 17° 01'E	45.2
14	N 48° 24'E	29.7
15	N 57° 01'E	58.1
16	S 37° 28'E	65.7
17	N 62° 48'E	35.1
18		

THE ESTATE OF ELZA G. JACKSON
HEIR, SIMPSONVILLE, GREENVILLE COUNTY, S.C.
SCALE: 1"=100'
11 OCT 1984

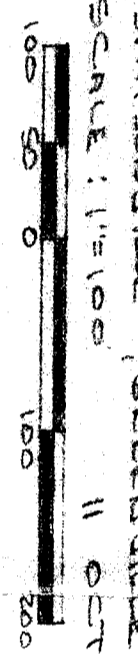

I certify that the Ratio of Precision of the Field Survey is 1/5000. As Shown Hereon And That the Area Determined By D.M.D. Method Or Area Method.

11969
10-2-19

CAROLINA SURVEYING CO.
112 HANLEY ST.
GREENVILLE, S.C.

R. B. BRUCE, R.L.S. #1982
RECORDING PLAN

283/16 417

329-1-S

MICROFILMED